

Catalogues

Search the CRAI UB catalogue and catalogues of other academic libraries at

http://cataleg.ub.edu/*eng

This page is optimized for mobile devices.

Loans

<http://crai.ub.edu/en/crai-services/loans/loansUB>

- ▶ With the UB student.
- ▶ BA and Erasmus degree students: **5 items for up to 10 days.**
- ▶ MA degree students: **10 items for up to 20 days.**
- ▶ Request and borrow items from other UB libraries within the UB, and return them to any library in the CRAI network.
- ▶ **Renewals:** At the loan desk, **by** telephone (934 021 662), or by logging into [My Account](#)
- ▶ **Reservations:** At the loan desk, or by logging into [My Account](#)
- ▶ **PUC:** free loan service between members of the [Consortium of University Services of Catalonia \(CSUC\)](#).
- ▶ **Laptop loan** laptops with dual boot systems GNU/Linux (Kubuntu) and Windows 7.
- ▶ **Interlibrary loan:** locate and obtain documents that are not held by the CRAI or at other Catalan universities. Fees apply: <http://crai.ub.edu/en/crai-services/loans/inter-library-loans>

WI-FI and EDUROAM

The UB offers two wireless networks. Further information: <http://wifi.ub.edu/> (in Catalan)

CRAI Mathematics Library

<http://crai.ub.edu/en/about-crai/libraries/mathematics>

Gran Via de les Corts Catalanes, 585
08007 Barcelona

Telephone: **934 021 662**

Opening hours: 8.00 am to 8.00 pm.,

Mondays to Fridays



MATHEMATICS CRAI LIBRARY



Universitat
de Barcelona



Information services and resources. User training

– Writing academic papers

Advice and support for students, for information searches, and academic writing: <http://crai.ub.edu/en/crai-services/writing-academic-papers>

– User training

Information and training related to CRAI, the libraries and, services, and information resources available to the university community. Further information: <https://cvformacio2.ub.edu/course/category.php?id=201>

Self-access learning options: tutorials, videos and quick guides for specific subject areas: <https://cvformacio2.ub.edu/course/category.php?id=206>

Virtual Campus

Moodle based e-learning platform for face-to-face and blended learning and, self-directed study. A UB login is required. Further information:

<http://campusvirtual2.ub.edu/>

Blog and Twitter

Social channels to build closer communication and interaction between the Library and its users

<http://bloccmat.ub.edu/> | <https://twitter.com/BibmatUB>



<http://crai.ub.edu/en/crai-services/sau>

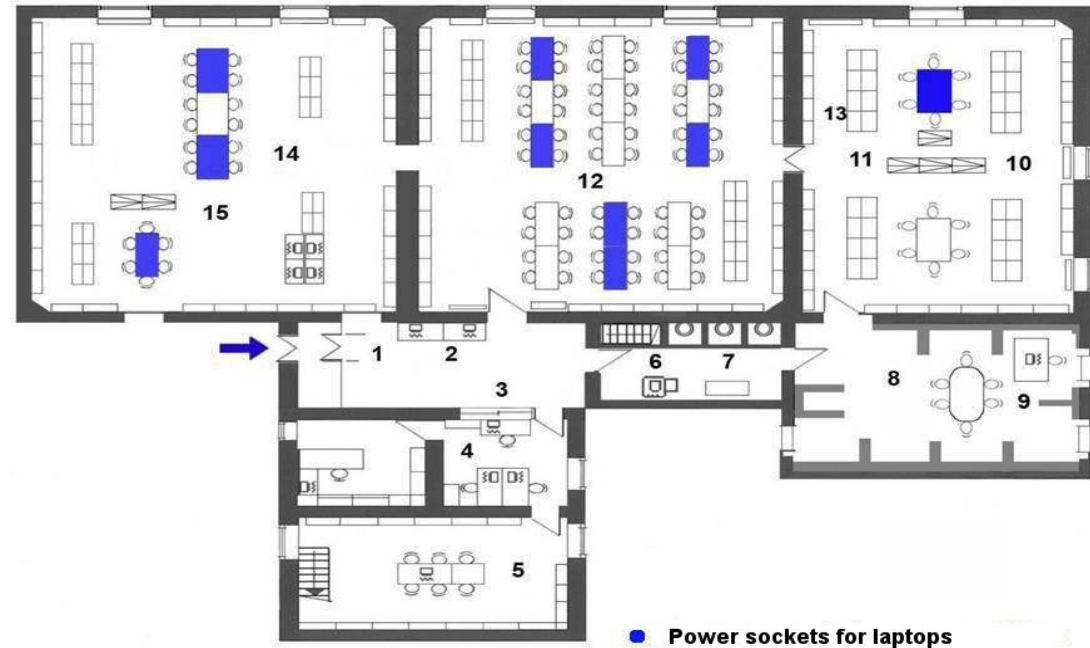

- | | |
|-------------------------------|----------------------------------|
| 1. Entrance/exit | 8 & 11. Journals |
| 2. Computers | 9. Computers |
| 3. Loan and Information desk | 10. Latest journal issues |
| 4. Staff offices | 13. Reference and thesis section |
| 5. Deposit | 12 & 14. Monographies |
| 6. Copier / Printer / Scanner | 15. Latest acquisitions |
| 7. Toilets | |

Print, Copy, Scan

All 7 computers are connected to the self-service copier machine.