

## Research and teaching support

We help teaching staff, research staff and students with different areas of their work, including management of the UB **Virtual Campus** and publication in institutional repositories

## Training

During the academic year, we organize training courses on the services and resources offered by the CRAI.  
Check for upcoming courses on the CRAI website

## Services and resources requiring

Use your **identifier (local username)** to access all services requiring **login**: Virtual Campus, MónUB, computers, WiFi, Cercabib, etc.

What is the **local username**?  
The left part of the UB email + *.alumnes*  
e.g.: **jproves6.alumnes**

The **password** is the same one that you use to log in into the Virtual Campus and MónUB

## Further information

Information on the resources and services of the UB's CRAI Libraries:

**crai.ub.edu**

## Opening hours and contact

Monday to Friday, 8:30 a.m. to 8:30 p.m.  
Weekends, 9:30 a.m. to 8.30 p.m.

Carrer Montalegre, 8  
08001 Barcelona

☎ 934 034 584 / 934 037 563

✉ craifgh@ub.edu



@craifgh

## User support service (SAU)

Online information service available **24/7** to answer your questions about CRAI libraries and their services and resources

## Help us to improve

Has this information been useful?  
Answer this short survey to help us improve:  
**[tinyurl.com/enquestaCRAI](https://tinyurl.com/enquestaCRAI)**



© CRAI UB  
Academic year  
2023-24

# PHILOSOPHY, GEOGRAPHY AND HISTORY CRAI LIBRARY



**CRAI**

Centre de Recursos per a  
l'Aprenentatge i la Investigació  
UNIVERSITAT DE BARCELONA

## Access with UB card is required

You must scan your UB card barcode at the barriers to enter the library

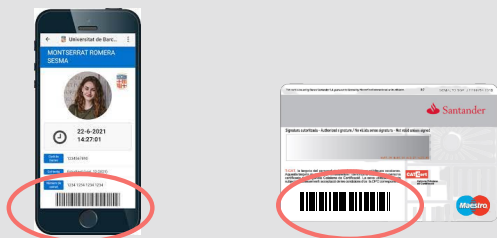

## How do I find the item I want?

**cercabib.ub.edu**



Remember to **log in** to access all available options. You can log in with:



### Local username

The left part of the UB email + .*alumnes*  
and your password\*  
e.g.: **jproves6.alumnes**

With the **Cercabib** tool, you can find digital and hard-copy documents.

For hard copies, the tool will specify where to find the documents in the Library.

Filosofia, Geografia i Història  
Check availability, Planta +1, ; 914.69 Est-4

\*The **password** is the same one that you use to log in into the MónUB and the Virtual Campus

## FLOOR + 1

**Geography and History**  
Topographies starting with **9**  
**Map collection**

## FLOOR 0

**Social Sciences and Anthropology**  
Topographies starting with **0** to **8**  
**Comic area**

## FLOOR -1

**Archaeology, Art, Philosophy**  
Topographies starting with **Arq, BA, F**  
**Newspaper archive and Media archive**

## Facilities

**14 study rooms and**  
**3 computer rooms**  
**12 laptops**  
**Returns box**  
**Chargers, headsets, book stands**

## Loan of UB documents and renewals

To take out an item on loan, you will need your UB card or ID document.

Renewals can be requested in the "**My account**" in **Cercabib**, at the loan desks, by phone or by e-mail

## Affiliated loans (PUC)

**Free** loan between the libraries in the Consortium of University Services (CSUC). It can be requested in person or through **Cercabib**

## Inter-library loans

Inter-library loans allow you to request documents that are not available from the CRAI or from libraries in the CSUC

## WiFi

There are two ways to access wireless connectivity:

### WiFi UB:

Local username and password\*  
(left part of UB mail + .*alumnes*)  
e.g.: **jproves6.alumnes**

### Eduroam (recommended):

Local username + @ub.edu and password\*  
e.g.: **jproves6.alumnes@ub.edu**

\*The **password** is the same one that you use to log in into the MónUB and the Virtual Campus